



ANTONINI
NAVI



LOUNGE 40





Lounge 40





FULVIO DE SIMONI

YACHT DESIGN



























NOE



NOE



noe

TECHNICAL SPECIFICATION

LOUNGE 40

Builder	Antonini Navi
Exterior & Concept Design	Fulvio De Simoni
Interior Design	HOT LAB
Engineering & Stability	Studio REDS

MATERIALS

Hull	Steel
Superstructure	Aluminium

CAPACITIES

Total fuel oil	49.000 litres approx.
Total fresh water	9.900 litres approx.
Tot.black/grey water	5.000 litres approx.
Urea	2.000 litres approx.
Tot. pool tank	4.000 litres approx.

DIMENSIONS

Length overall (LOA) (excl. bulb)	40.0 m approx.
Length waterline (LWA)	39.60 m approx.
Beam moulded	8.30 m approx.
Beam max	8.91 m approx.
Draft at full load	2.30 m approx.
Displacement (full load)	354 t approx.
GROSS TONNAGE (ITC '69)	<400 GT

PERFORMANCE

Max speed	15.0 kts
Comfort speed	12.0 kts
Range @10 kts	4.000 nm approx.

PROPULSION

Main Engines	2x 1.066kW - MAN 2862LE489
Generators	2x 100 kW - KOHLER

GENERAL ARRANGEMENT

LOUNGE 40

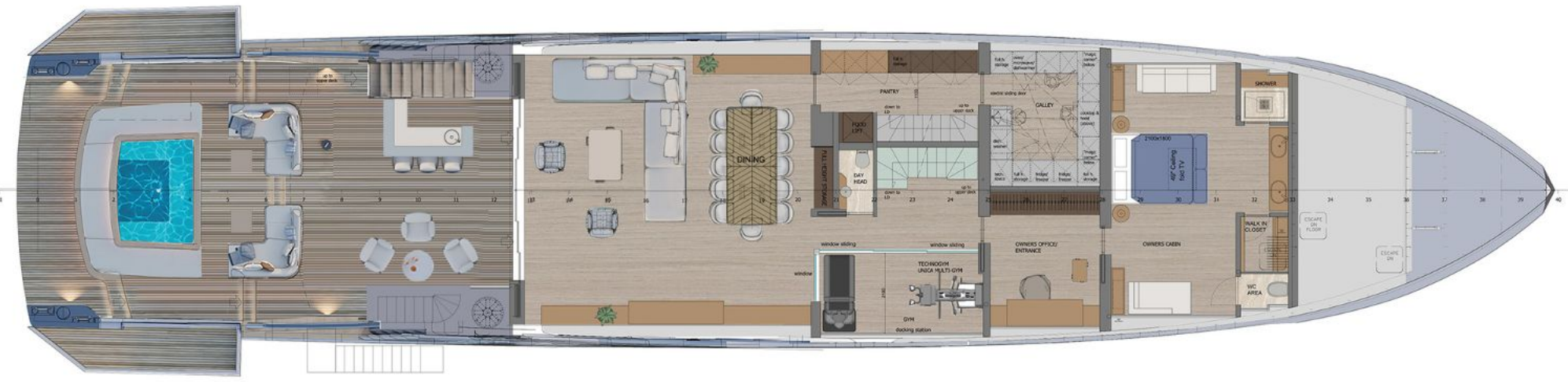

SUN DECK

LOUNGE 40



UPPER DECK

LOUNGE 40



MAIN DECK

LOUNGE 40

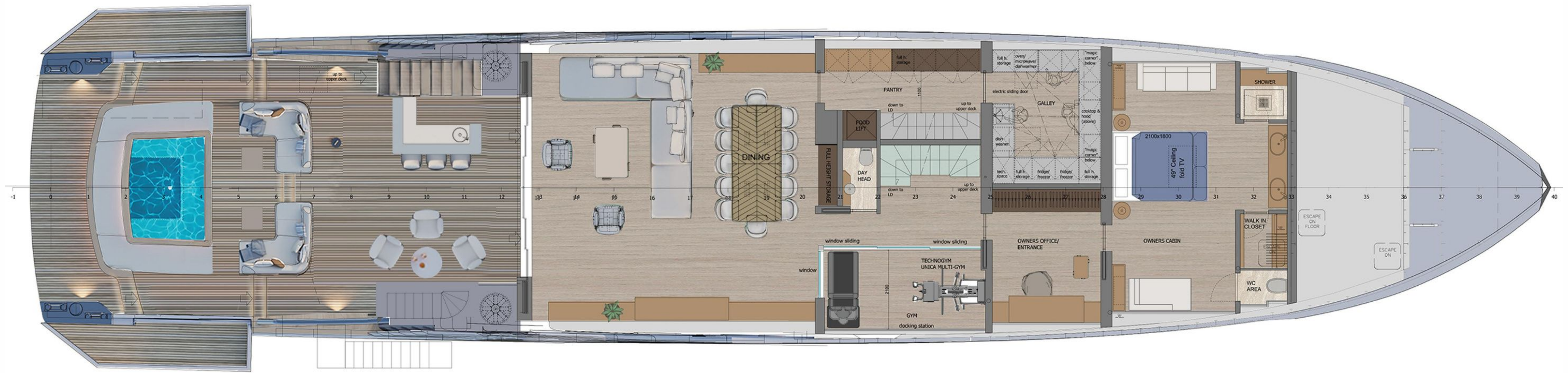

LOWER DECK

LOUNGE 40











ANTONINI
N A V I

ANTONINI NAVI S.R.L

SEDE LEGALE E STABILIMENTO:

LOCALITÀ PERTUSOLA - FRAZIONE MUGGIANO - 19032 LERICI (LA SPEZIA) -ITALY

PH +39 0187 1771300

INFO@ANTONININAVI.COM

WWW.ANTONININAVI.COM - WWW.GRUPPOANTONINI.IT